

HS-5055MG General Specification.

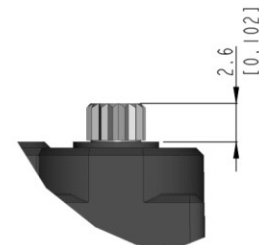

Control System	PWM			-
Position Sensor Type	Contact Analog Potentiometer			-
Motor Type	Cored Metal Brush			At the Max voltage, it is recommended to be used only for a short time duration.
Operating Voltage Range	3.5 ~ 8.4V			
Voltage	4.8V	6.0V	-	At 25°C(±10%), 45%RH(±10%) <u>measurement environment</u>
No Load Speed	0.20sec/60°	0.17sec/60°	-	
Stall Torque	1.3kgf-cm (18.1 oz-in)	1.6kgf-cm (22.2 oz-in)	-	
Peak Efficiency Torque	0.3kgf-cm (4.2 oz-in)	0.3kgf-cm (4.2 oz-in)	-	
Standing Current	8mA	8mA	-	
No Load Running Current	120mA	150mA	-	
Stall Current	560mA	700mA	-	
Deadband	6μs	6μs	-	
Operating Travel	Default: ±60°, Programmable: Max 175° / Pulse Width: 900~2100μs(Center:1500μs)			
Continuous Rotation	n/a			
Operating Temperature Range	-20°C ~ +60°C (-4°F ~+140°F)			-
Storage Temperature Range	-30°C ~ +80°C (-22°F ~+176°F)			-
Connector Wire Length	250mm (9.843inch)			
Connector Wire Gauge	28AWG			
Dimensions	22.8mm x 11.6mm x 24.0mm (0.898inch x 0.457inch x 0.945inch)			General Tolerance ±0.1mm
Weight	9.5g (0.335oz)			Excluding the weight of Horn
Bearing Type	n/a			-
Case Material	Engineering Plastic			-
Gear Material	1 Resin & 4 Metal Gears			-
Gear Train Backlash	Max 0.5°			-
Horn Gear Spline	15T(Ø4.0)			-
IP-Rating	IP4X			-
Servo Amplifier Type	8bit Programmable Digital			-

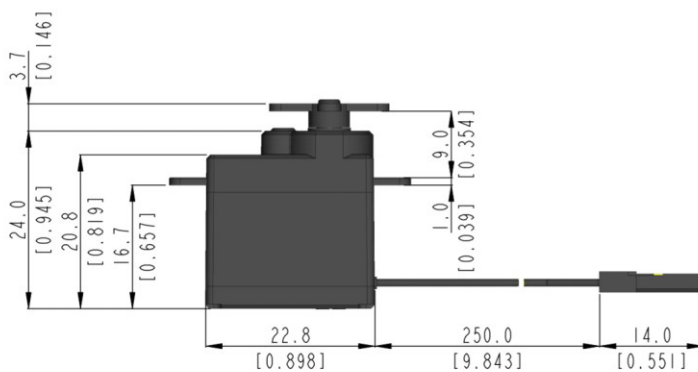
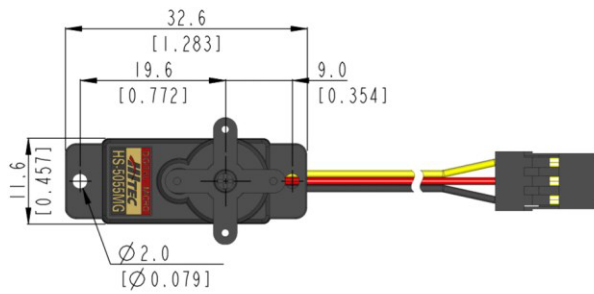

1:1 scale (Unit : mm[inch])

- This product should not be used directly on the human body for medical purposes.
- All specifications are subject to change without notice.



9001:2015
14001:2015
CERTIFIED



HitecCS.com