

HS-5125MG General Specification.

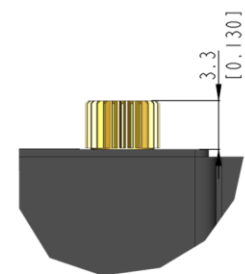

| | | | | |
|-----------------------------|--|------------------------|---|---|
| Control System | PWM | | | - |
| Position Sensor Type | Contact Analog Potentiometer | | | - |
| Motor Type | Cored Metal Brush | | | At the Max voltage, it is recommended to be used only for a short time duration. |
| Operating Voltage Range | 3.5 ~ 8.4V | | | |
| Voltage | 4.8V | 6.0V | - | At 25°C(±10%), 45%RH(±10%) <u>measurement environment</u> |
| No Load Speed | 0.18sec/60° | 0.14sec/60° | - | |
| Stall Torque | 2.8kgf-cm (38.9 oz-in) | 3.3kgf-cm (45.8 oz-in) | - | |
| Peak Efficiency Torque | 0.6kgf-cm (8.3 oz-in) | 0.7kgf-cm (9.7 oz-in) | - | |
| Standing Current | 3mA | 3mA | - | |
| No Load Running Current | 180mA | 230mA | - | |
| Stall Current | 1,100mA | 1,400mA | - | |
| Deadband | 2μs | 2μs | - | |
| Operating Travel | Default: ±60°, Programmable: Max 175° / Pulse Width: 900~2100μs(Center:1500μs) | | | |
| Continuous Rotation | n/a | | | |
| Operating Temperature Range | -20°C ~ +60°C (-4°F ~+140°F) | | | - |
| Storage Temperature Range | -30°C ~ +80°C (-22°F ~+176°F) | | | - |
| Connector Wire Length | 300mm (11.811inch) | | |  |
| Connector Wire Gauge | 22AWG | | | |
| Dimensions | 30.0mm x 10.0mm x 34.0mm (1.181inch x 0.394inch x 1.339inch) | | | General Tolerance ±0.1mm |
| Weight | 24.0g (0.847oz) | | | Excluding the weight of Horn |
| Bearing Type | 2 Ball Bearing | | | - |
| Case Material | Engineering Plastic | | | - |
| Gear Material | 1 Metal-Plastic & 4 Metal Gears | | | - |
| Gear Train Backlash | Max 0.5° | | | - |
| Horn Gear Spline | M25T(Ø5) | | | - |
| IP-Rating | IP4X | | | - |
| Servo Amplifier Type | 8bit Programmable Digital | | | - |

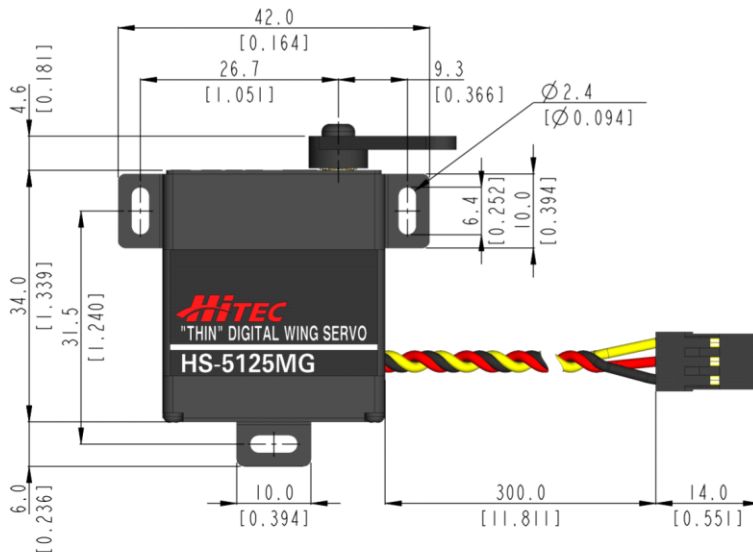
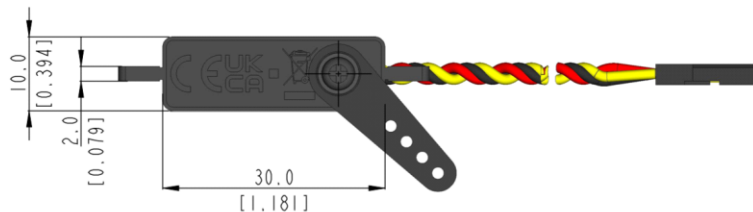

1:1 scale (Unit : mm[inch])

- This product should not be used directly on the human body for medical purposes.
- All specifications are subject to change without notice.



9001:2015
14001:2015
CERTIFIED



HitecCS.com